

Installation Guidelines For



Indoor Rubber Flooring Interlocking



Reg #SCS-FS-02144

This product has been certified by SCS to meet the rigorous indoor air quality requirements of the FloorScore® certification program.

The following pages are guidelines, if not followed, warranty will be voided. Please read this manual thoroughly before installing Dinoflex Recycled Rubber Surfacing products.

Tel: (250) 832-7780

Fax: (250) 832-7788

Toll Free Tel: (877) 713-1899

TABLE OF CONTENTS

<u>SECTION</u>		<u>PAGE</u>
I	GENERAL INFORMATION	3
PRODUCT		
II	MATERIAL STORAGE & HANDLING	
	General Packaging Info	3
	Receipt of Merchandise	3
	Storage	3
III	TOOLS & ACCESSORIES	
	Tools and Safety Equipment	4
	Reducer Strips	4
INSTALLATION		
IV	SUB-SURFACE	
	Preparation of sub-surface	4
	Concrete	4-5
	Wood	5
V	PREINSTALLATION	
	General Information	5
	Chalk Lines	6
	Mat Layout	6
	Acclimation – Dry Lay Process	6-7
	Cutting	7
VI	INSTALLATION	
	Installation Information	7
	Logo Information	7-8
	Logo Installation	8
CLEANING		
VII	POST INSTALLATION CLEANING	8
FLOOR TREATMENT		
VIII	RECYCLED RUBBER TREATMENT	8-9

SECTION I – GENERAL INFORMATION

- Product Information:
 - Thickness tolerance of $\pm 0.5\text{mm}$
 - Dimensions: $37'' \times 37'' = 9.5 \text{ ft}^2$ (94cm x 94cm) Dimension tolerance of $1/8''$ (3.2mm)

SECTION II – MATERIAL STORAGE & HANDLING

General Information:

- All Dinoflex products are packaged on wooden pallets, covered with a plastic cozy, and secured by metal strapping. (image below does not include metal strapping)



Receipt of Merchandise:

- It is recommended you double-check your order is correct.
- Inspect for any damage that may have occurred during transportation.
- Identify any other possible shortcomings.
- For your own protection, ensure that defective product is identified prior to the start of the installation.
 - Notify your sales rep regarding any defective product immediately.
- Dinoflex is not responsible for any installation costs that occur because of defective product being installed.

Storage

- Store product in a dry and clean area.
- Before placing any Dinoflex product in storage remove the pallet strapping.
- Leave plastic cozy on during storage.

SECTION III – TOOLS & ACCESSORIES

Tools and Safety Equipment

- Dinoflex Installation Guidelines
- Safety glasses
- Rubber gloves and boots

- Heavy duty utility knife
- Measuring tape
- Transit level and straight edge
- Chalk snap-line
- Carpenter's square
- Putty knife
- Masonite board, plywood or kraft paper
- 858ml adhesive caulking gun, if needed to adhere reducer strip

Reducer Strips:

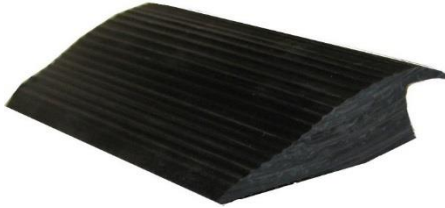

Sizes:

- 5/16" (8mm) x 12' length
- 3/8" (10mm) x 12' length
- 1/2" (12mm) x 12' length

SECTION IV – SUB-SURFACE

Preparation of the Sub-surface

- The sub-surface must be flat/smooth, clean, and dry, structurally sound and all debris including old adhesive must be removed.
 - Scraping may be required to remove debris.
- Particleboard, chipboard, Masonite, and Lauan Plywood are not considered suitable underlayment.
- If installing on an incline surface, start at the bottom and move up the surface to avoid sliding of the mats.
- Debris left under mats will cause height variations, telegraphing and undulations.

Concrete Sub-Surface

- New concrete sub-floors must be thoroughly cured and free from hydrostatic pressure (a minimum of 30 days after pour).
- Concrete substrates should not exceed 90% RH and/or 5lbs x 24-hours x 1000 sq. ft.
- It is essential that pH tests be taken on all concrete floors. This must range between 7 and 9. If it does not, the sub-floor must be neutralized prior to the beginning of the installation. **These tests must be documented.**
- Moisture vapor emissions test in accordance to ASTM F1869 and relative humidity in concrete test in accordance to ASTM F2170 must be completed.
- Sub-surface must be smooth and level to a tolerance not exceeding 1/8" in 10 lineal feet.
 - The Concrete Surface Profile (CSP) must achieve a requirement of CSP2.
- If existing concrete is too rough, or does not meet the above criteria, apply a Portland cement based leveling compound to smooth and level the surface. Follow all leveling compound manufacturer's instructions.
- Warranty is not applicable if specified moisture ranges are not adhered to.

Wood Sub-Surface

- Wood sub-surface must be sealed for installation to be completed.
- Wood sub-surface must be a minimum of 1" thickness, and free from any flex movement. (5/8" on joists with a 3/8" overlay is acceptable).
- New plywood should be acclimatized for a 48-hour period prior to installation of the rubber flooring.
- CDX exterior smooth one side is suggested for new wood substrates.
- Secure all nails and screws to prevent future protrusion.
- Any cracks, holes, rough or uneven areas should be patched with a polymer-modified cement leveling compound and/or sanded to achieve a smooth surface.
- It is vital that a moisture test be completed prior to installation with records kept. No less than 20 spot checks per 1000 sq. ft. should be observed. Any readings higher than 13% are not acceptable and installation must wait until levels are at or under 13%.
- Warranty is not applicable if specified moisture ranges are not adhered to.

SECTION V – PRE-INSTALLATION

General Information

- Prior to installing Dinoflex Recycled Rubber Flooring, ensure all other trades have completed their work schedules.
- The use of Masonite board, plywood or kraft paper should be used to protect the rubber flooring from damage and debris.
- Product and sub-floor must be of the same temperature. This should be checked using an infrared digital thermometer.
- Dinoflex is not responsible for any product failure if proper floor preparation and/or installation procedures are not followed.
- Check ambient temperature:
- All HVAC systems must be fully operational 24-hours prior to beginning the acclimation process.
- Rubber flooring may be installed between temperatures of 14°C (57°F) and 23°C (72°F).
 - Room temperature must be consistent during the entire installation.
 - Large fluctuations in temperature or humidity will cause expansion or contraction.
- In-floor radiant heat should be shut off for 24-hours prior to acclimation (72-hours prior to installation), be shut off throughout installation and remain off for 72-hours after installation is complete.
 - It is recommended that surface temperature does not exceed 25°C (77°F)

Chalk Lines

- Locate the midpoint of the room, chalk a start line down the center. Chalk another similar start line 90° to the first one. (Figure 1)

Figure 1

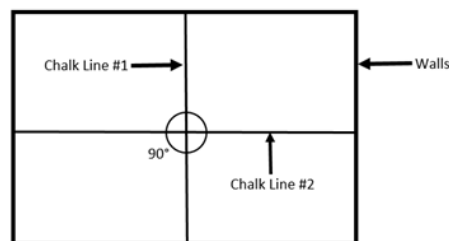

Mat Layout

- Each mat is designed with an arrow indicating the direction each mat should be installed
 - Install mats same side up as received, **Do Not Flip Over**
- The installer should have all relevant information about the mat arrangement from the owner.
- Begin mat layout from the point where the two chalk lines intersect.
- Work outwards in both directions.
- Start second row on either side of the center line towards the chalk line.
- Make sure that second row is installed by staggering mats.
 - This will avoid any four corners from meeting at one spot. (see figure 2)

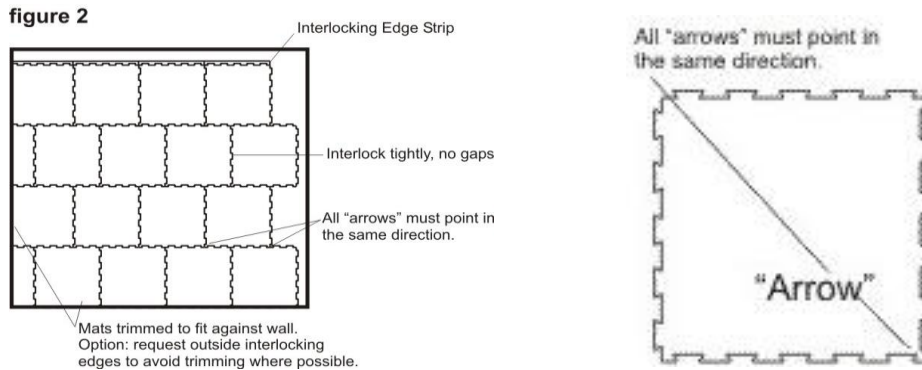

Acclimation and Dry Lay

- **Acclimation/Dry Lay Checklist is required to be completed or warranty will be void.**
- A minimum of 48 – 72 hours before starting the installation.
 - Storage longer than 2 weeks will require a longer acclimation period.
 - Mats in the lower portion of the stack will compress to a greater degree than those in the upper portion.
 - A mat laid down in the morning hours at 0°C (32°F) would be a different size than a mat laid at 20°C (68°F) later in the day.
 - Acclimation should only begin once the sub-surface has reached a temperature between 14°C (57°F) and 23°C (72°F).
- Lay out all mats on the sub-surface in piles of 2 or less:
 - Be sure to mix mats from several different pallets to blend minor shade variations.
 - Allow them to acclimate until they have reached a consistent size.
 - Some products under certain conditions have shown expansion and contraction in size of up to 1/8" (3.2mm).
 - Check for any shading or uneven color distribution.
 - This is **not** considered to be a product defect.
 - Rotating the mat 90° or installing it in a less visible area may help improve the effect.
 - Inspect all mats for visible defects.
 - Ensure the defective product is identified prior to the start of the installation, notify Rep/Dealer immediately.
 - Labor will not be covered if any defective product is installed.
 - Scythe marks are inherent in the manufacturing of recycled rubber flooring products and are considered normal.
 - Certain lighting conditions can accentuate these marks and as such is not considered a product defect.

Cutting

- Lay mat on a flat surface, hold the metal straight edge on the cut line, and cut with sharp utility knife.
- Keep scoring the cut until separated.
- Change or snap off blades frequently to ensure clean cuts.
- For odd angles, circular patterns, etc. a cardboard template is suggested.
- Join factory edges together. Hand cut edges should be used against the perimeter walls only.

SECTION VI-INSTALLATION

Installation Information

- **Do not install** mats if the appropriate thickness and dimensions have not been reached.
- Intended for indoor use only and should not be installed in areas where the temperature is inconsistent.
- For a multistage install on larger projects, any unretained edges will need to be anchored with double sided tape until the installation resumes.
 - Failing to secure the open edges will result in shifting of the surface and gaps between the tiles.
- Any perimeter tile will need to be cut to fit against the wall, allow a ¼" inch around the perimeter for expansion and contraction.
 - Create a finish straight edge by removing all interlocking tabs along the outside edge. (See Cutting section for directions)
 - Make sure all tiles must be laid with the arrow pointing in the same direction.

General Logo Information

- All logos are assembled at the factory prior to being shipped to ensure a precise fit has been achieved.
- Logos do not ship assembled.
- Logo pieces are labelled and supplied with reference graphic for installation.
- Use care when handling logo pieces to protect them from damage or loss.
- Logos are packaged depending on size:
 - One mat logos are usually packaged in a separate box.
 - Larger logos are packaged on top of the pallet.
 - Smaller pieces are always packaged separately in either a plastic bag or small box.

Logo Installation

- Before starting the logo installation, confirm required logo location from site drawings or by confirming with building owner.
- Acclimate and Dry Lay as per guidelines previously mentioned above.
- While Acclimating and Dry laying tape all logo piece in place. (low tack painters' tape may be used to hold pieces in place during this step, but tape must be removed immediately after logo is installed).
- Carefully remove logo and place to the side.
- Carefully place background mat and logo pieces into place, starting with larger pieces.
- Gently adjust pieces to ensure a good fit.
- Continue to install surrounding floor, being careful to protect logo from all traffic.
- Cover with Masonite board, plywood or kraft paper until the remainder of the installation is complete.

VII – CLEANING

Post Installation Cleaning

- When installation is complete:
 - Sweep floor to remove any debris, then dust mop thoroughly to remove all surface dust and dirt using a dust mop or microfiber mop.
 - Use a neutral PH Cleaner or DinoClean. (see dilution rates on label).
 - Do not use any oil base cleaners as they will deteriorate the mats.
 - Damp mop with DinoClean Concentrated Recycled Rubber Floor Cleaner diluted with a warm water; use a microfiber mop.
 - Use a two-bucket system and change the water frequently.
 - If floor has an excessive amount of dirt or dust present, additional cleaning with a lightweight auto scrubber may be required.
 - An RPM of 185 and brush pressure between 35 and 85lbs are recommended.
 - If disc type equipment is used, be sure to use a soft nylon brush, not a pad.
 - Do not flood floor.
 - Allow to dry thoroughly.
 - Apply a treatment of DinoCoat according to instructions provided by Dinoflex if desired.

VIII – FLOOR TREATMENT

Recycled Rubber Treatment

- Please note that treating recycled rubber is not required for all applications.
- Mats with a predominance of light-colored EPDM will be easier to clean and maintain if treatment is applied.
- Contact your Dinoflex Supplier for the correct choice in your application.
- For most installation, it is not necessary to seal or coat Dinoflex Recycled Rubber Mats.
- In certain installations, a treatment may be appropriate.
- DinoCoat is recommended to improve the visual effects of shade variation and uneven distribution of color granules.
- Application Guide:
 - Preparation:
 - Ensure floor has been completely cleaned and free of any dust, dirt or debris.
 - Ensure floor is completely dry before applying DinoCoat
 - Isolate or close off area(s) that will have DinoCoat applied
 - Line mop bucket with garbage bag to eliminate DinoCoat from entering the bucket and eliminate the possibility of foreign substance or unwanted chemicals
 - Applying DinoCoat:
 - Pour DinoCoat into a bucket, using a roller or microfiber mop and slightly wringing it out so the mop is fully saturated but not dripping.
 - Apply a thin coat starting at the entrance way and outline the room along the baseboards, do a 180° turn back to the 3rd wall and cover the rest of the area working back and forth. (See below image)
 - Set up all caution/wet floor signs to ensure there is no traffic on floor while DinoCoat is drying.
 - DinoCoat must be completely dry before applying subsequent coats (minimum 1 hour). Drying times will vary with temperature, humidity and ventilation.
 - When applying second coat, be sure to move in opposite direction from first coat.
- DinoCoat is recommended to improve the visual effects of shade variation and uneven distribution of color granules.

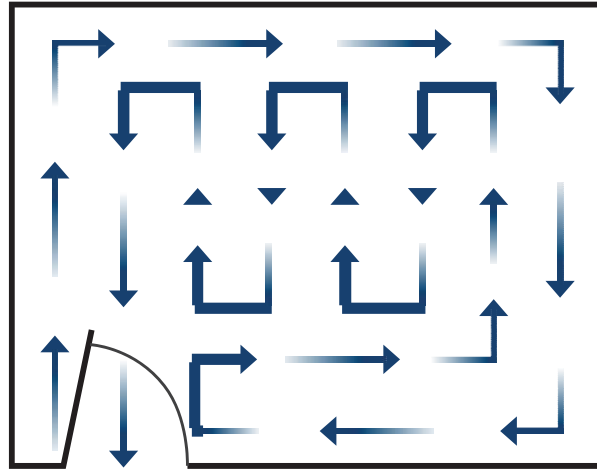

Dinoflex Recycled Rubber Innovators
P.O. Box 3309
5590 – 46th Ave S.E.
Salmon Arm, B.C. V1E 4S1

www.dinoflex.com

Tel: (250) 832-7780
Fax: (250) 832-7788
Toll Free Tel: 1-877-713-1899
Email: sales@dinoflex.com