



Cleaning & Maintenance Guideline

Indoor Rubber Flooring

Square Cut

A) Post Installation Cleaning

- When flooring installation is complete, and adhesive is fully cured:
 - Sweep floor to remove any debris, then dust mop thoroughly to remove all surface dust and dirt using a dust mop or microfiber mop.
 - Damp mop using DinoClean or a neutral PH cleaner diluted with warm water using a microfiber mop (see dilution rates on label).
 - Use a two-bucket system and change the water frequently.
 - Do not use any oil base cleaners as they will deteriorate the mats.
 - If floor has been unprotected during construction and an excessive amount of dirt or dust is present additional cleaning with an auto scrubber may be required.
 - An RPM of 185 and brush pressure between 35 and 85lbs are recommended.
 - If disc type equipment is used, be sure to use a soft nylon brush, not a pad.
 - Do not flood floor.
 - Allow to dry thoroughly.
 - Apply a treatment of DinoCoat according to instruction provided by Dinoflex if desired.

B) General Maintenance

Sealed/Non-Sealed Floors

- Typically, Dinoflex Recycled Rubber Flooring requires less maintenance than other types of flooring.
 - Sweeping then damp mopping with a microfiber mop is the preferred method.
 - Do not use a string mop
 - Use a two-bucket system with DinoClean or a neutral PH cleaner and change water frequently.
 - Products containing solvents and acids will attack the composite structure of the rubber flooring and cause deterioration.
 - Sealants, waxes, etc. can alter the surface characteristics and appearance.
 - Dinoflex does not assume any responsibility for damages caused by chemical additives.
 - If a protective coating such as DinoClean is used, be sure to apply a coating after cleaning.

C) Floor Treatment

- Please note that treating recycled rubber is not required for all applications.
- Mats with a predominance of light-colored EPDM will be easier to clean and maintain if treatment is applied.
- Contact your Dinoflex Supplier for the correct choice in your application.



- For most installation, it is not necessary to seal or coat Dinoflex Recycled Rubber Mats.
- In certain installations, a treatment may be appropriate.
- DinoCoat is recommended to improve the visual effects of shade variation and uneven distribution of color granules.
- If DinoCoat is recommended for you installation, please follow the below application guide to reapply DinoCoat:
 - Preparation:
 - Ensure floor has been completely cleaned and free of any dust, dirt or debris.
 - Ensure floor is completely dry before applying DinoCoat
 - Isolate or close off area(s) that will have DinoCoat applied
 - Line mop bucket with garbage bag to eliminate DinoCoat from entering the bucket and eliminate the possibility of foreign substance or unwanted chemicals
 - Applying DinoCoat:
 - Pour DinoCoat into a bucket, using a roller or microfiber mop and slightly wringing it out so the mop is fully saturated but not dripping.
 - Apply a thin coat starting at the entrance way and outline the room along the baseboards, do a 180° turn back to the 3rd wall and cover the rest of the area working back and forth. (See below image)
 - Set up all caution/wet floor signs to ensure there is no traffic on floor while DinoCoat is drying.
 - DinoCoat must be completely dry before applying subsequent coats (minimum 1 hour). Drying times will vary with temperature, humidity and ventilation.
 - When applying second coat, be sure to move in opposite direction from first coat.

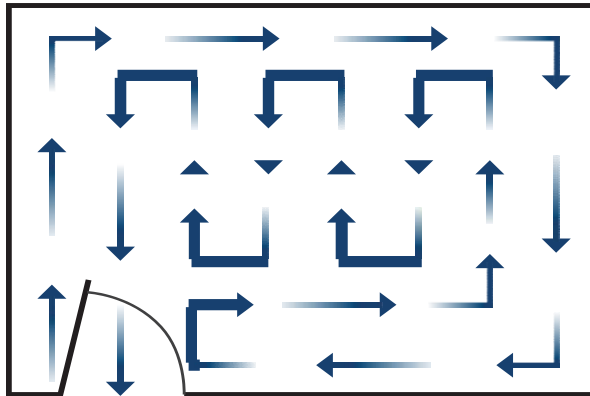

For additional information, please contact your Dinoflex Sales Representative, or for additional technical assistance, contact Dinoflex Recycled Rubber Innovators.

Dinoflex Recycled Rubber Innovators
 P.O. Box 3309
 5590 – 46th Ave S.E.
 Salmon Arm, B.C. V1E 4S1 Canada

Tel: (250) 832-7780
Fax: (250) 832-7788
Toll Free: 1-877-713-1899
E-mail: sales@dinoflex.com

www.dinoflex.com

